

Location:
 Plano Gateway Office Park
 525 Shiloh Rd
 Suite 1400
 Plano, TX 75074

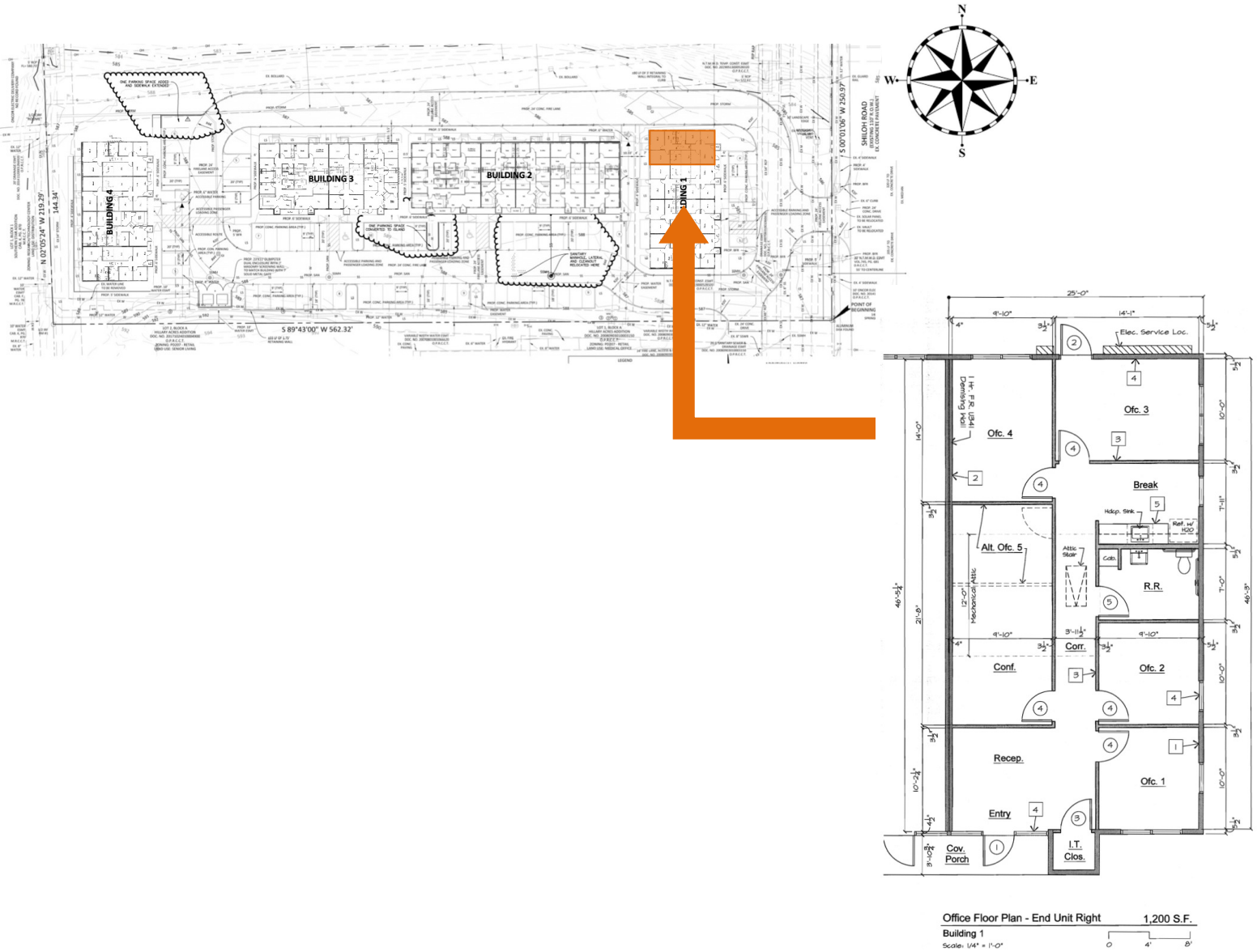

Space Available:
 Fully Finished Out
 Professional Office Available
 1,200 SF

Site / Floor Plan



The information contained herein was obtained from sources deemed reliable; however Legacy Commercial LLC. makes no guarantees, warranties or representations as to the completeness or accuracy thereof, the presentation of this real estate information is subject to errors: omissions; change of price; subject to prior sale or lease; or withdrawal without notice.

FOR MORE INFORMATION CONTACT
 O: 972.292.1220 / www.LCRTexas.com
 Joe Martinez C: 214.535.1876 / Tito Martinez 972.533.3621
Martinez@LCRTexas.com / Tito@LCRTexas.com